



Visitor's Map and Hours

The National Archives Building

700 Pennsylvania Avenue NW, Washington, DC 20408
1-86-NARA-NARA • 1-866-272-6272

Research Hours (Closed on Sundays and Federal Holidays)

Mon	Tue	Wed	Thur	Fri	Sat
8:45 A.M.	8:45 A.M.	8:45 A.M.	8:45 A.M.	8:45 A.M.	8:45 A.M.
5:00 P.M.	9:00 P.M.	5:00 P.M.	9:00 P.M.	9:00 P.M.	4:45 P.M.

Archives-Navy Memorial    Metr rail Station



RESEARCH ENTRANCE

Enter here to Conduct Research

THE NATIONAL ARCHIVES EXPERIENCE

EXHIBIT ENTRANCE

Enter here to view the Declaration, Constitution, & more

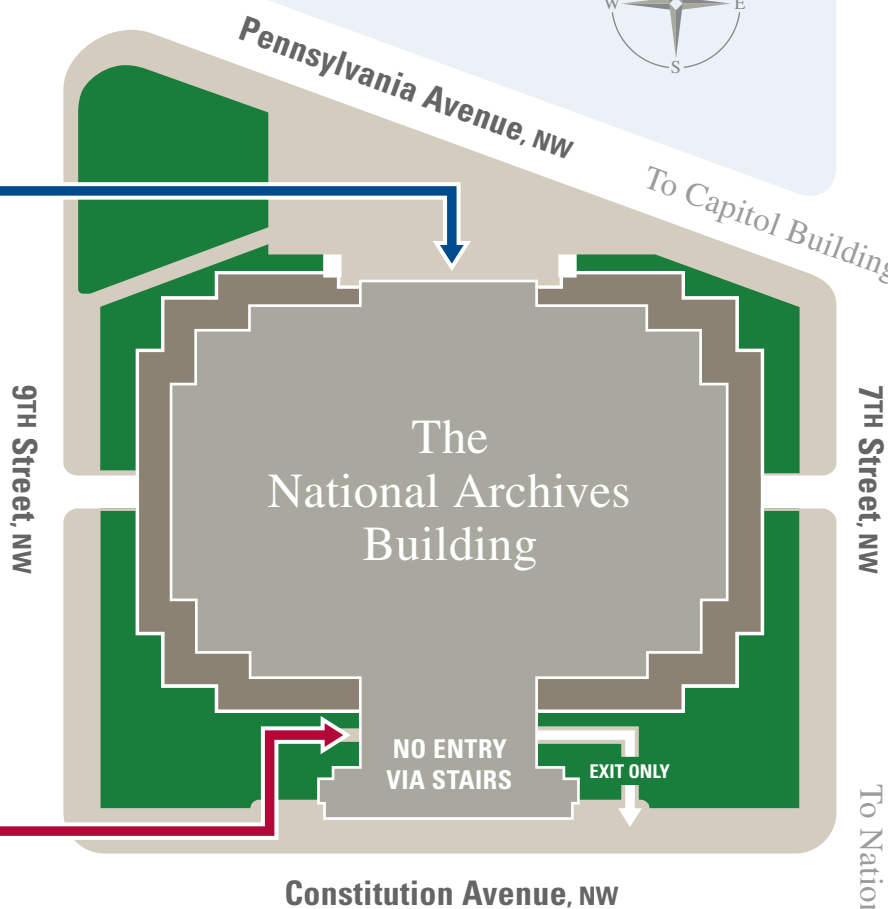

Exhibit Hours (Exhibits open every day except December 25th. Hours vary by season.)

Fall & Winter Seasons (Day after Labor Day through March 31)

10:00 A.M.–5:30 P.M. (every day, except closed on December 25)

Spring Season (April 1 through the Friday before Memorial Day Weekend)

10:00 A.M.–7:00 P.M. (every day)

Summer Season (Memorial Day Weekend through Labor Day)

10:00 A.M.–9:00 P.M. (every day)

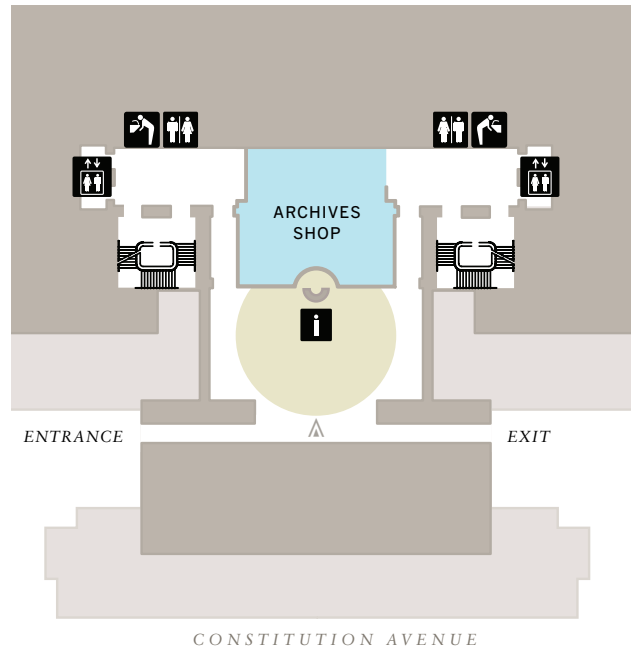

Entrance/Exit GROUND LEVEL

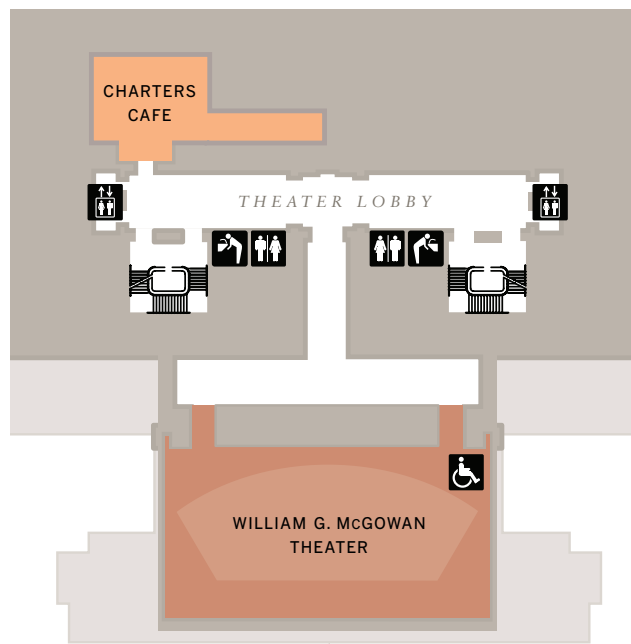

Theater LOWER LEVEL

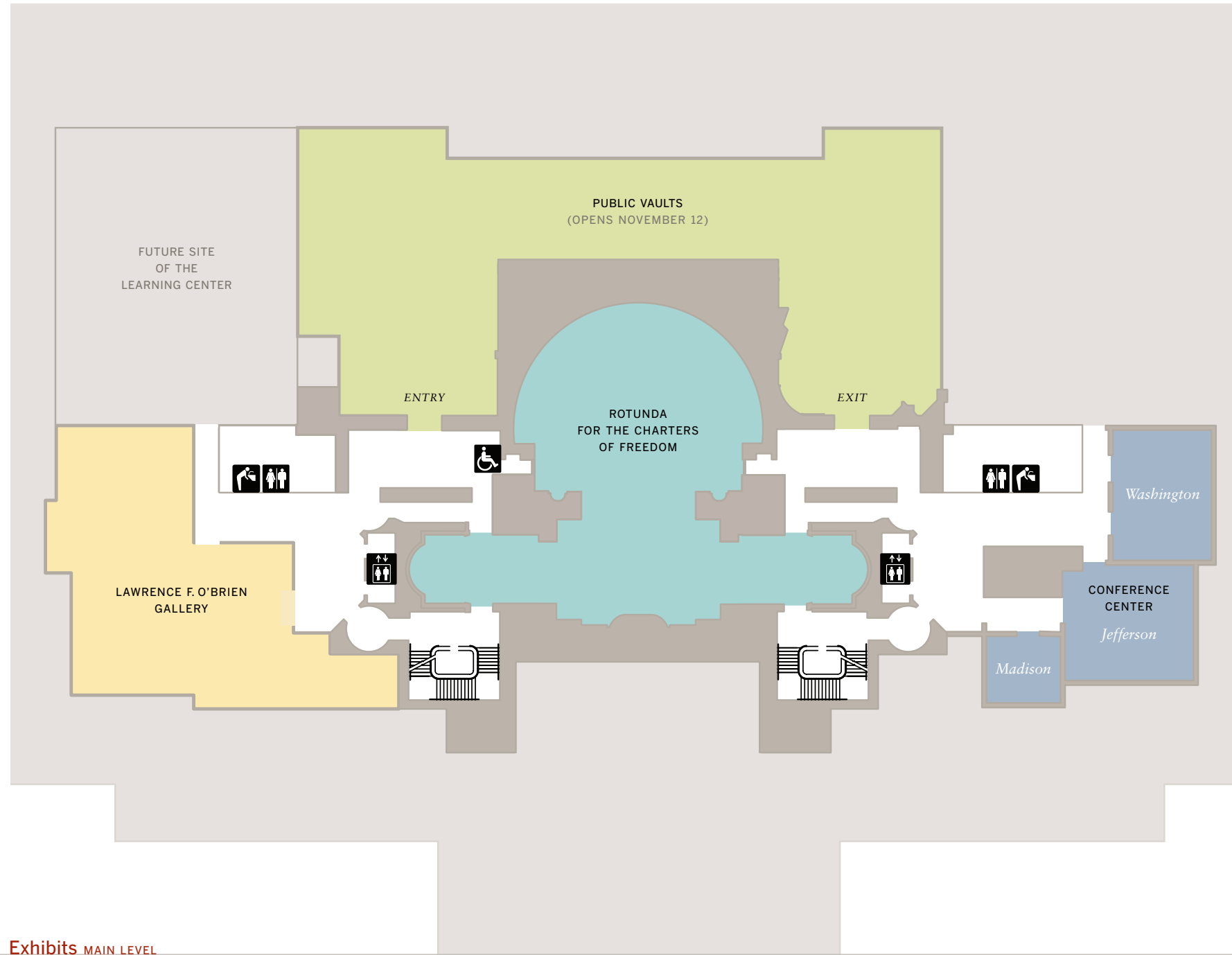

Exhibits MAIN LEVEL



THE
NATIONAL
ARCHIVES
EXPERIENCE

Exhibits MAIN LEVEL

- Lawrence F. O'Brien Gallery
- Public Vaults
- Rotunda for the Charters of Freedom
- Conference Center
Washington Room
Jefferson Room
Madison Room

Entrance/Exit GROUND LEVEL

- Visitor Services
Information Desk
Wheel Chairs
Lost and Found
First Aid
- Archives Shop

Theater LOWER LEVEL

- Charters Cafe
- William G. McGowan Theater